

**INSWING TILT & TURN WINDOW**

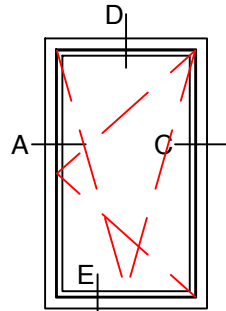

680-11-TT

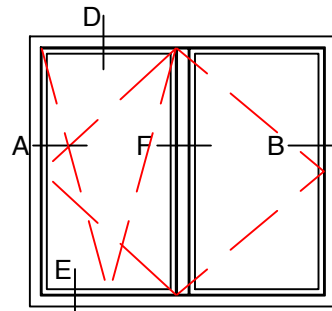

680-21-FR-TT  
\*SECONDARY UNABLE TO TILT

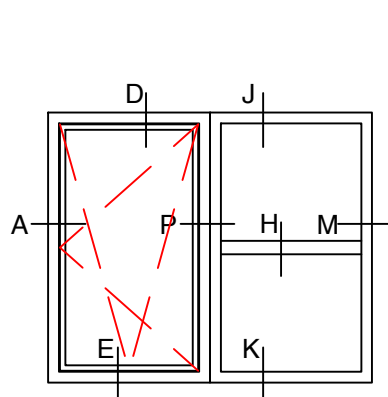

680-22-TT-FX

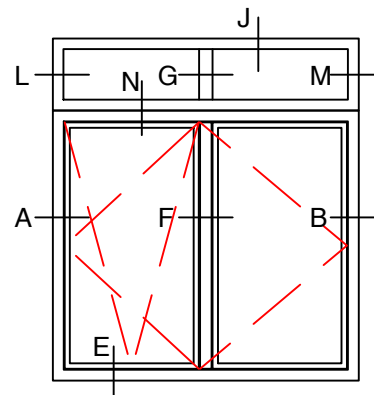

680-22-FR-TT-FX  
\*SECONDARY UNABLE TO TILT

# KEY (TYPICAL)

1. SNAP IN ALUMINUM GLAZING BEAD
2. WEDGE GASKET
3. 1" GLASS AND GLAZING (BY OTHERS)
4. WEATHER STRIPPING
5. METRO TILT & TURN HINGE

\*TILT & TURN HARDWARE IS CONCEALED

6. METRO HANDLE

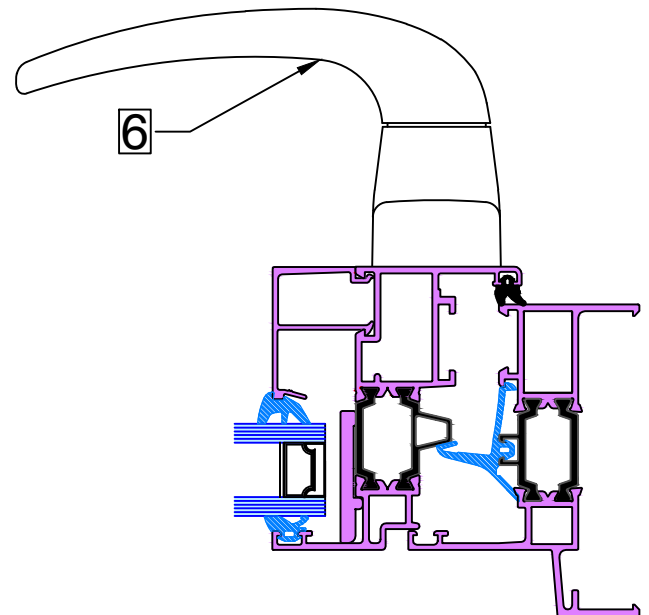
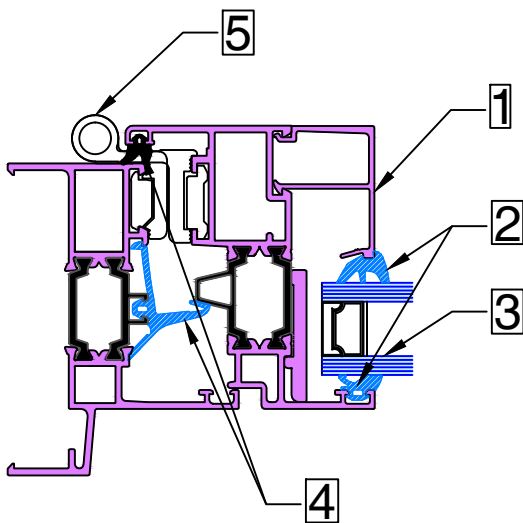

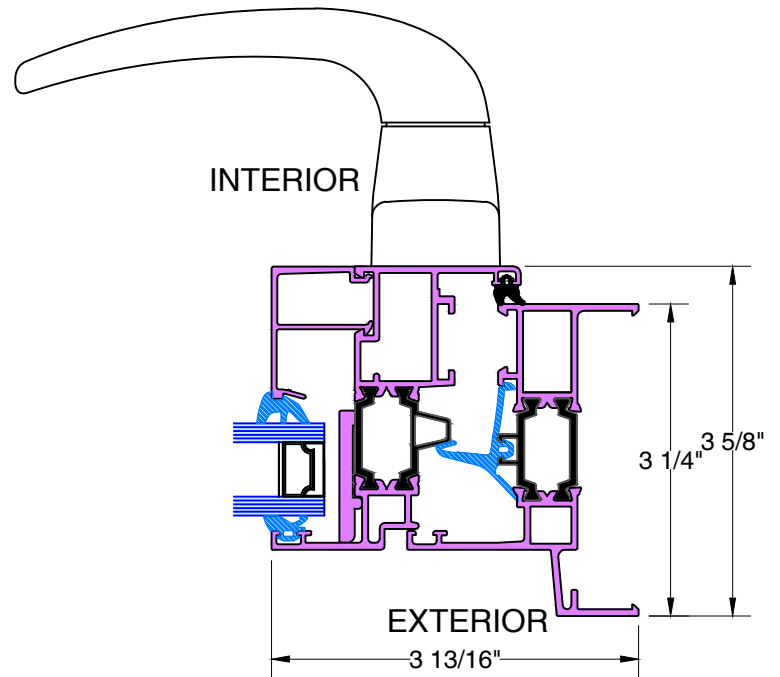
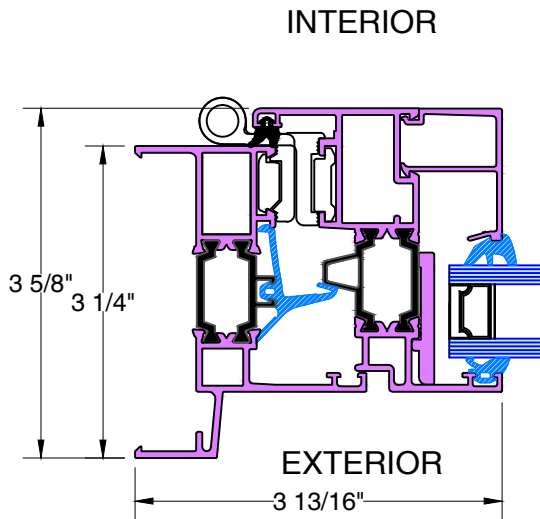

**A&B** TYPICAL HINGED JAMB

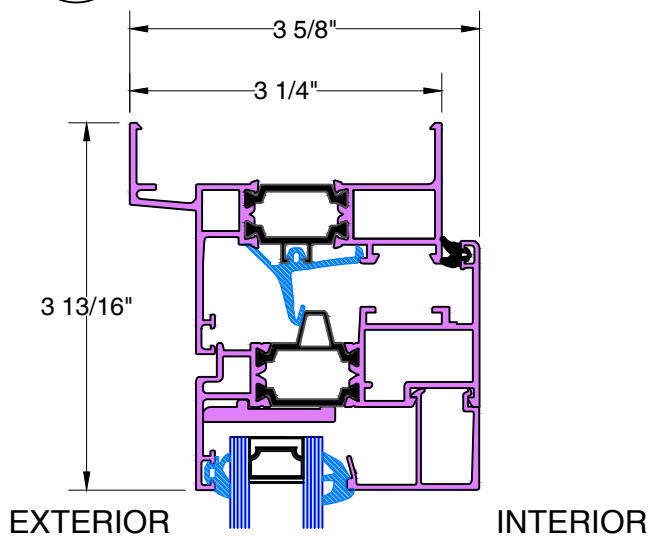

**C** TYPICAL LOCKING JAMB

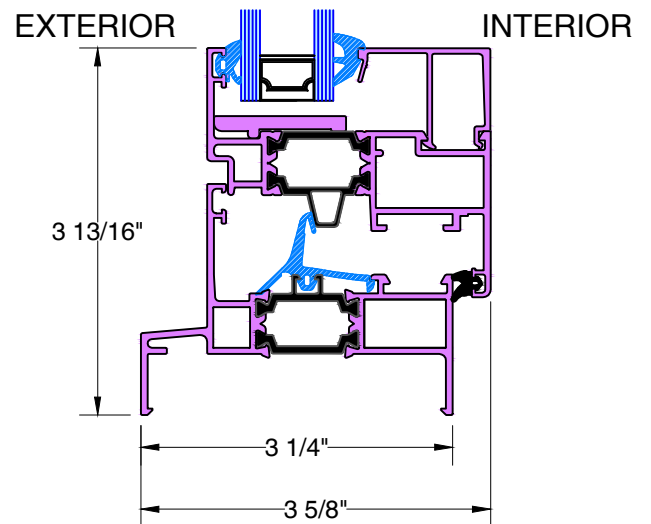

**D** TYPICAL HEAD

**E** TYPICAL SILL

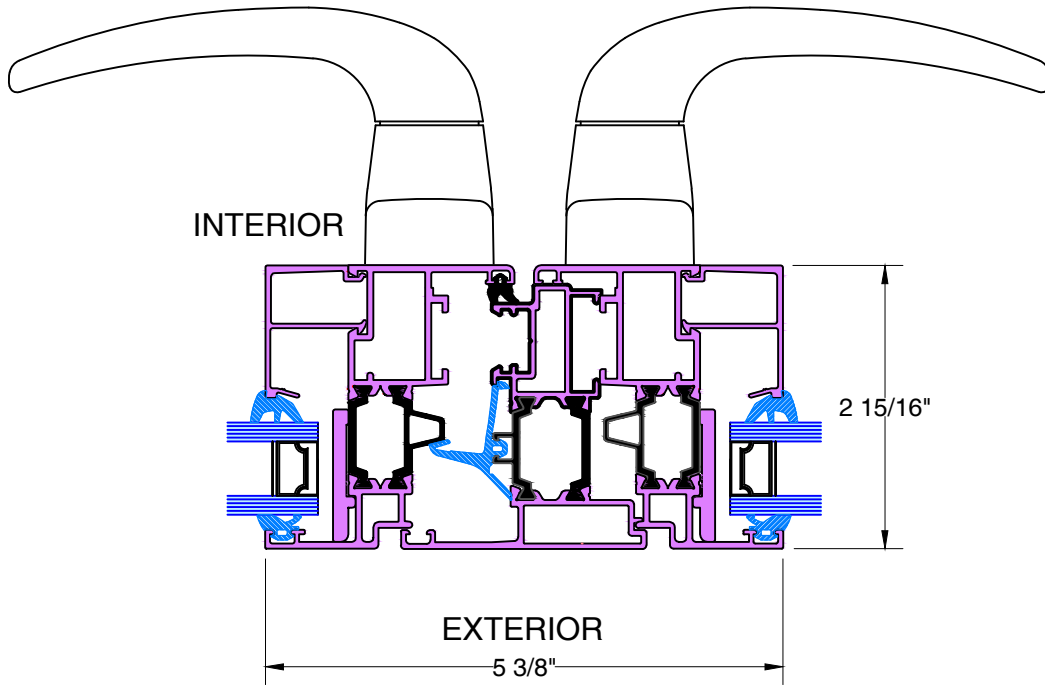

**F** TYPICAL FRENCH MEETING RAIL

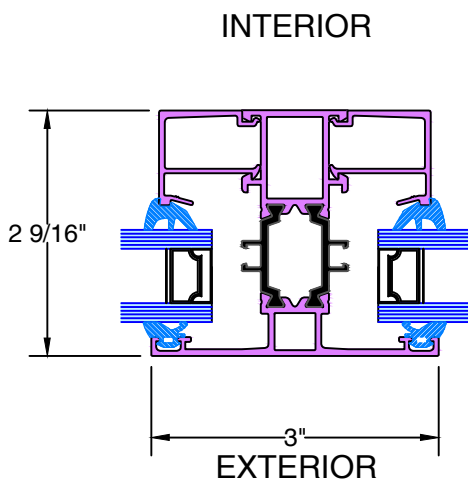

**G** TYPICAL VERTICAL MUNTIN

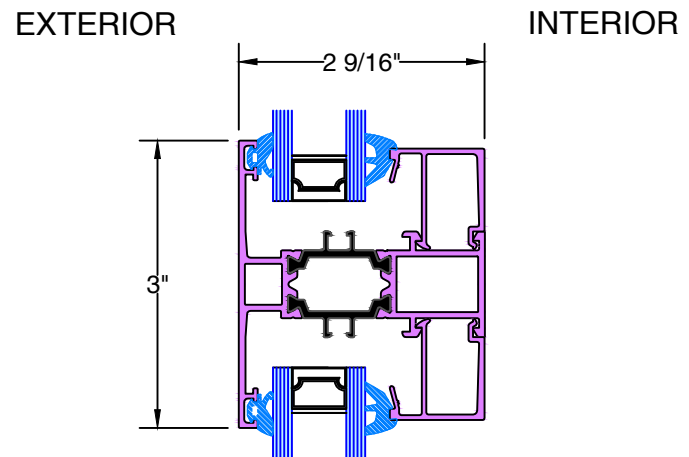

**H** TYPICAL HORIZONTAL MUNTIN

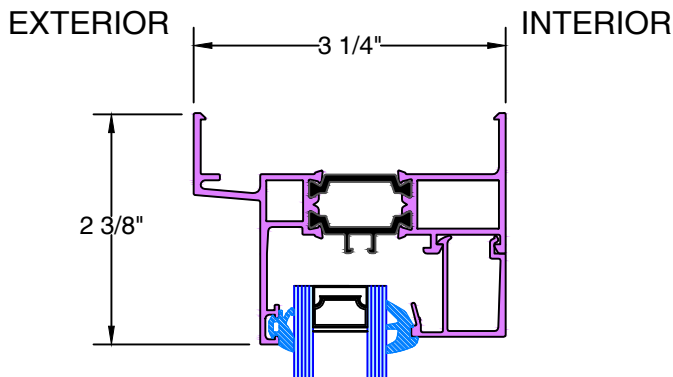

**J&K** TYPICAL FIXED HEAD & SILL

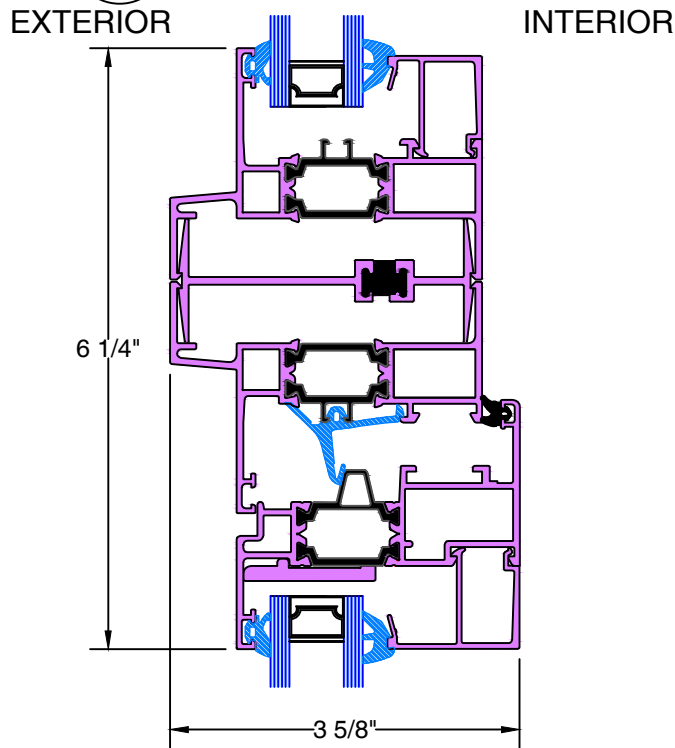

**N** TYPICAL STACKING MULLION

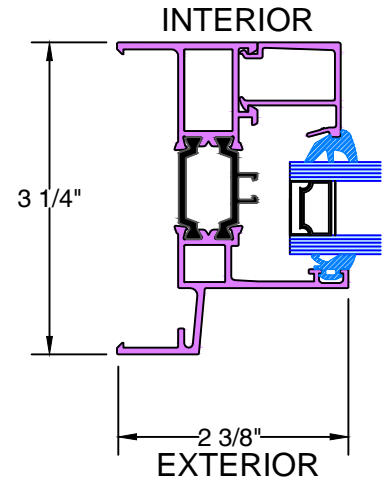

**L&M** TYPICAL FIXED JAMB

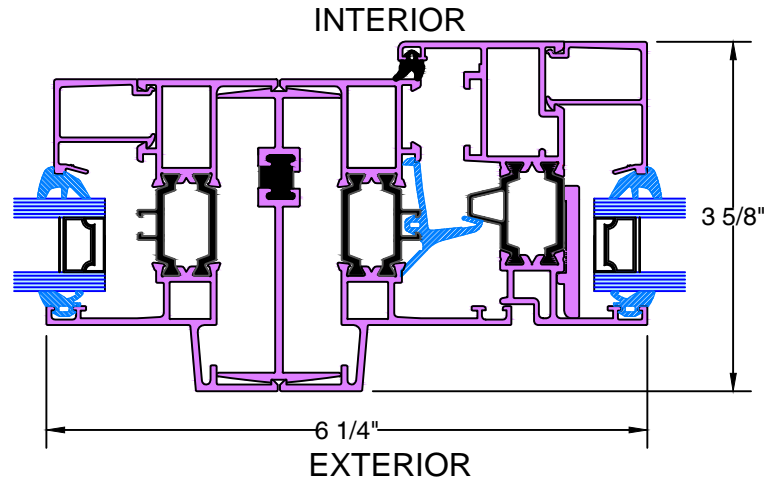

**P** TYPICAL JOINING MULLION