

Typical Exterior Elevations

INSWING TERRACE DOORS / FIXED

Scale: Not To Scale

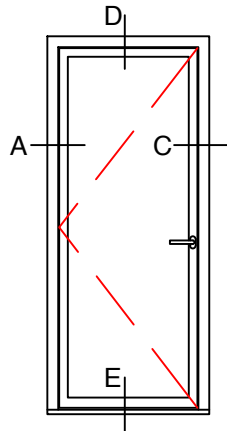

680-11-ITD

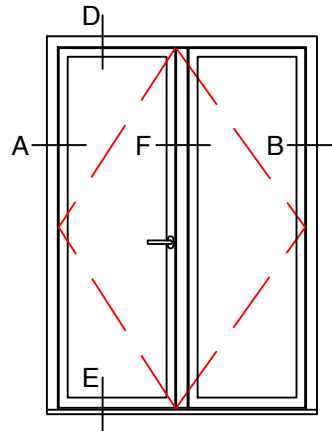

680-21-FR-ITD

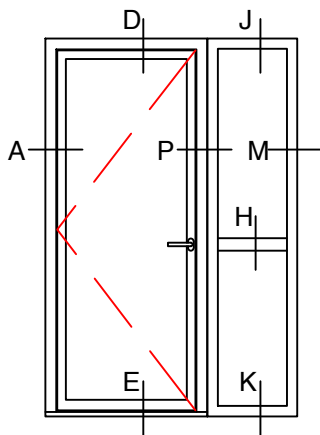

680-22-ITD-FX

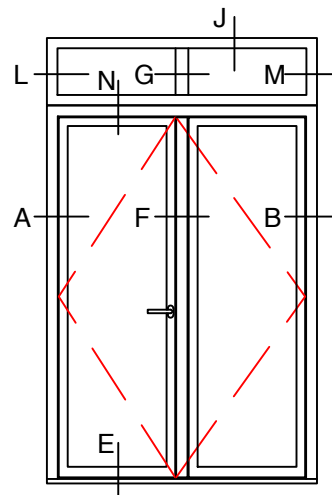

680-22-FR-ITD-FX



Typical Details

INSWING TERRACE DOORS / FIXED

Scale: Half Scale

PAGE 2 OF 5

KEY (TYPICAL)

1. SNAP IN ALUMINUM GLAZING BEAD
2. WEDGE GASKET
3. 1" GLASS AND GLAZING (BY OTHERS)
4. WEATHER STRIPPING
5. METRO HINGE
6. METRO HANDLE (OTHER OPTIONS AVIABLE)

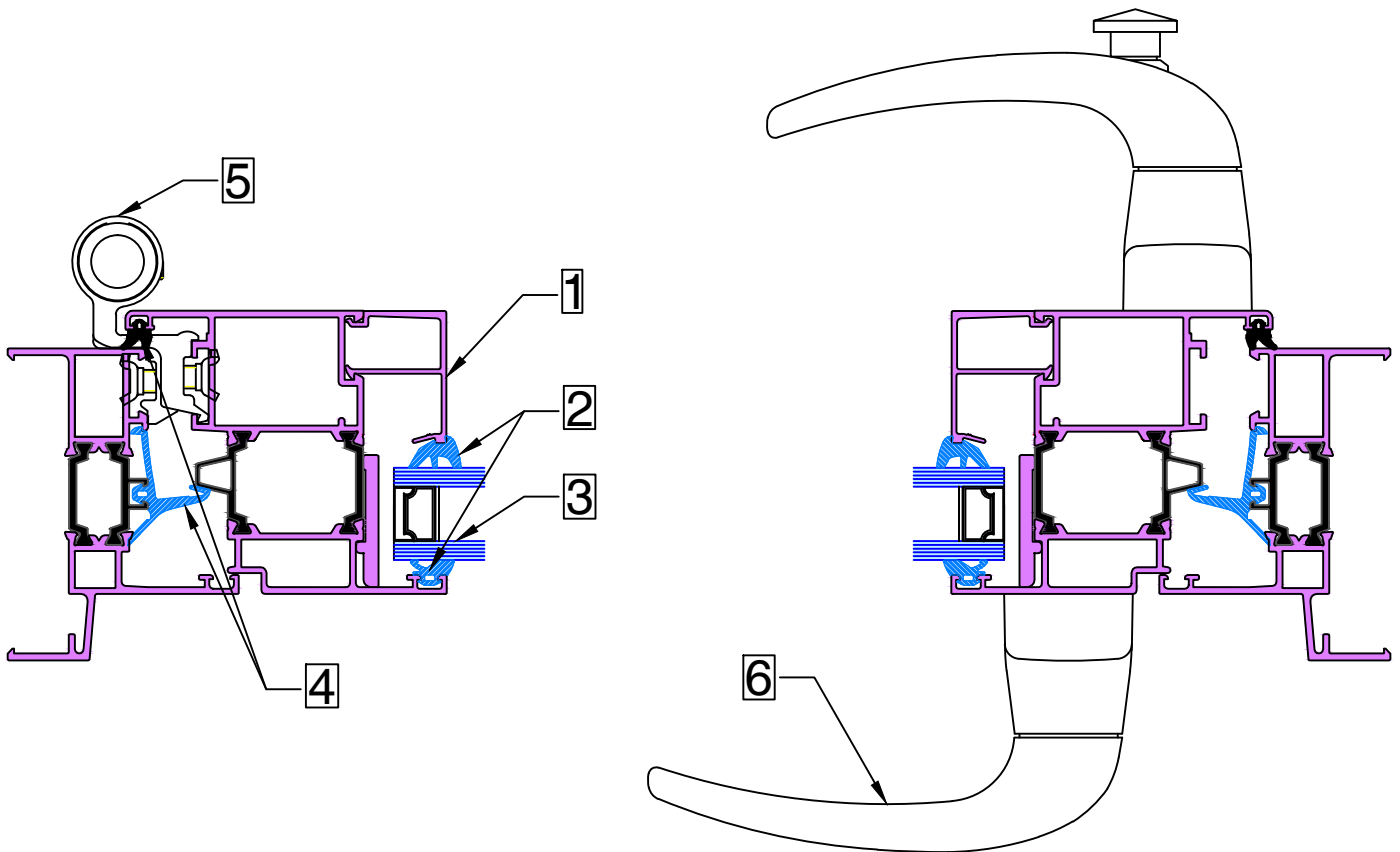

28 Canal Street, Ellenville, NY 12428

Phone (845) 647-1900

Typical Details

INSWING TERRACE DOORS / FIXED

Scale: Half Scale

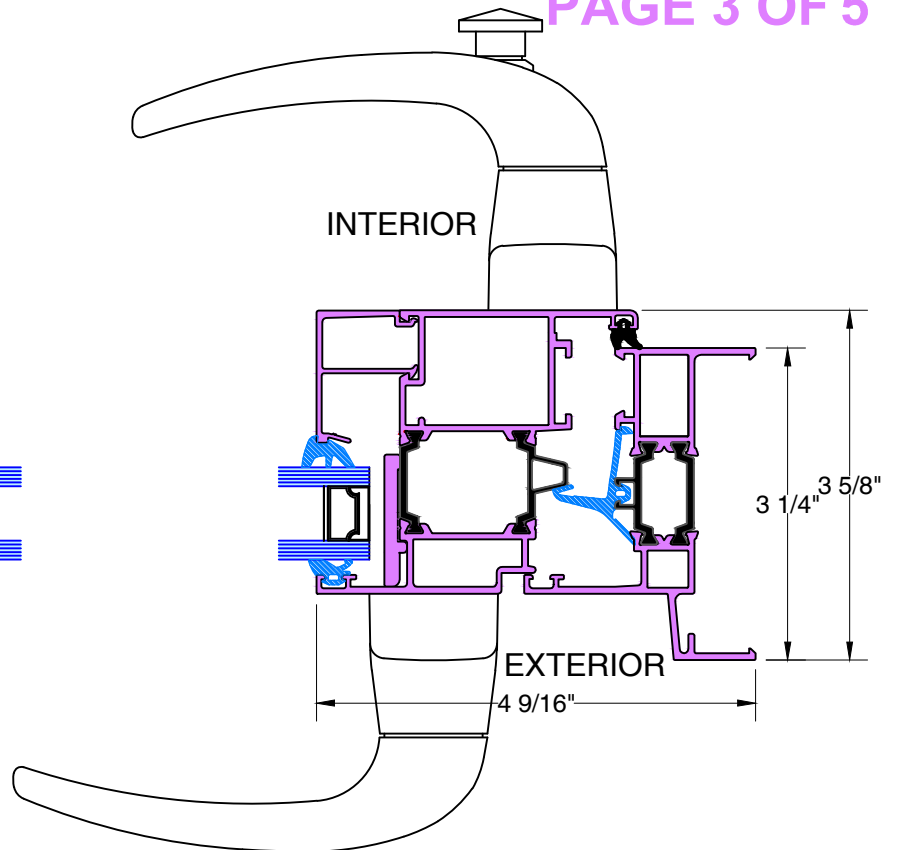
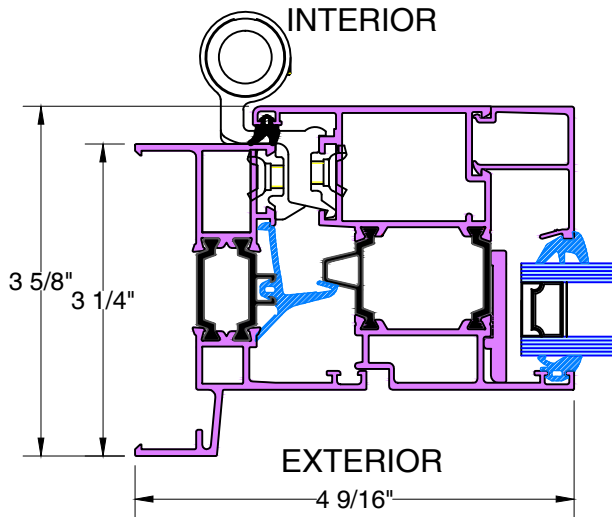

A&B TYPICAL HINGED JAMB

C TYPICAL LOCKING JAMB

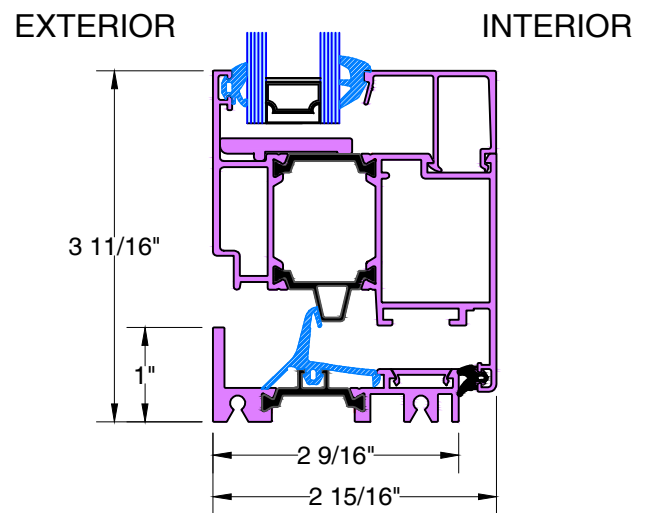
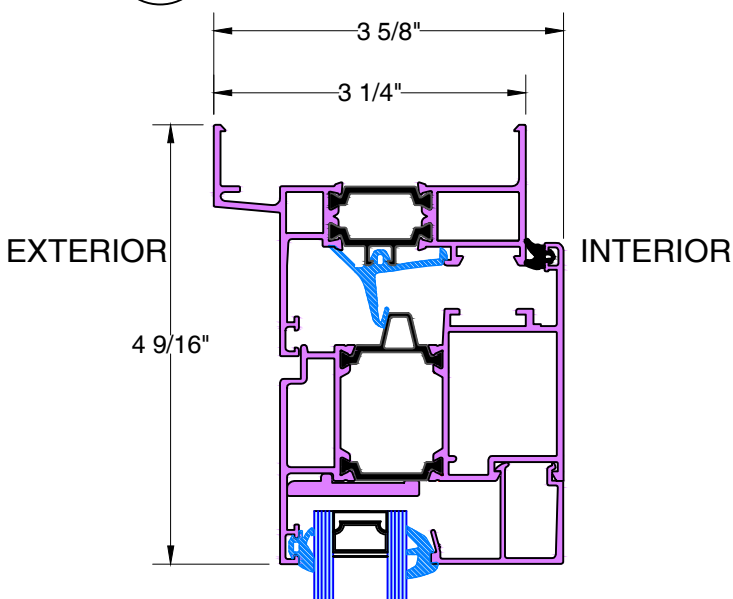

D TYPICAL HEAD

E TYPICAL KICKPLATE



Typical Details

INSWING TERRACE DOORS / FIXED

Scale: Half Scale

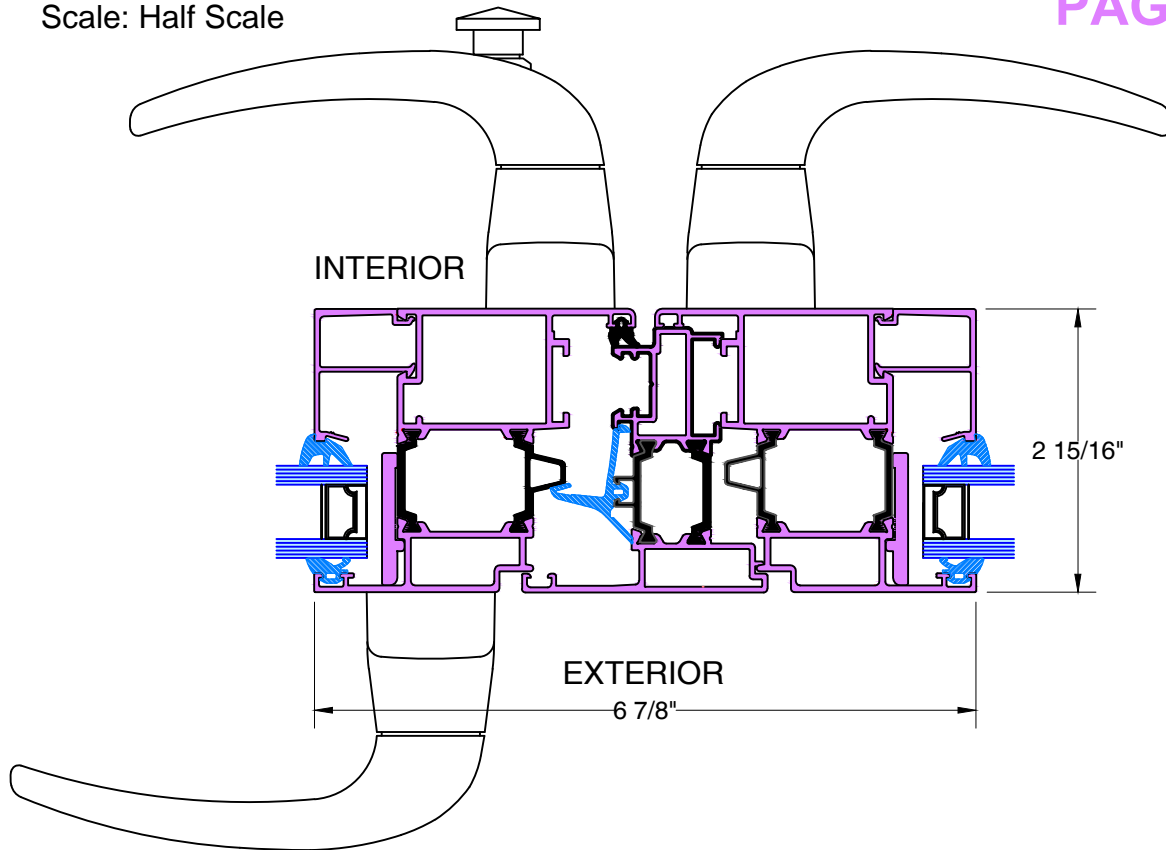

F TYPICAL FRENCH MEETING RAIL

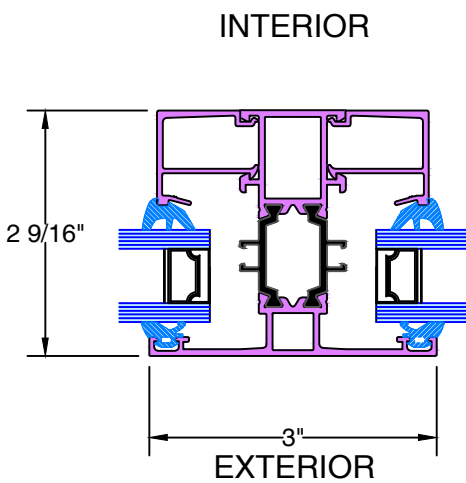

G TYPICAL VERTICAL MUNTIN

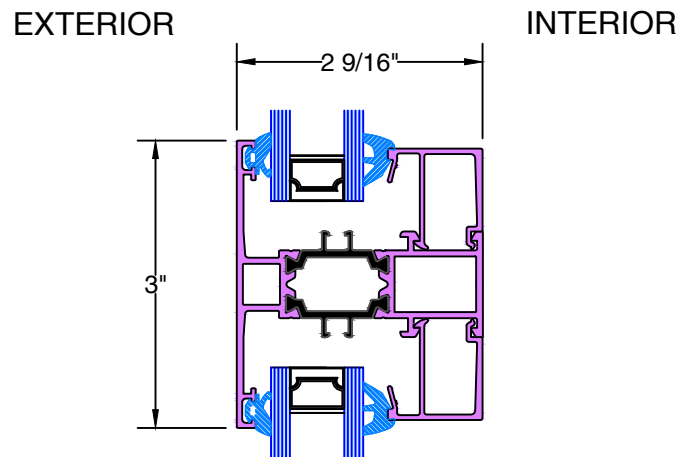

H TYPICAL HORIZONTAL MUNTIN



Typical Details

INSWING TERRACE DOORS / FIXED

Scale: Half Scale

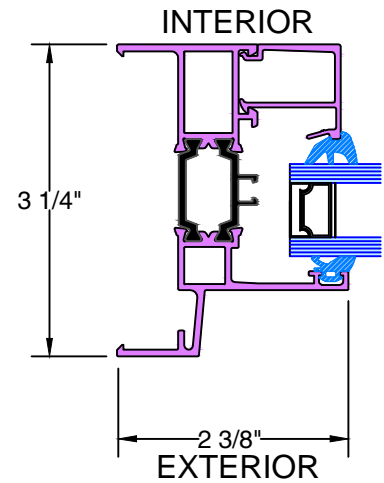
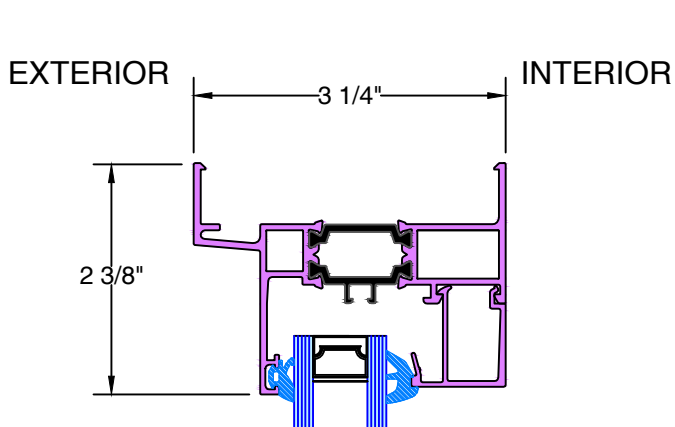

J&K TYPICAL FIXED HEAD & SILL

L&M TYPICAL FIXED JAMB

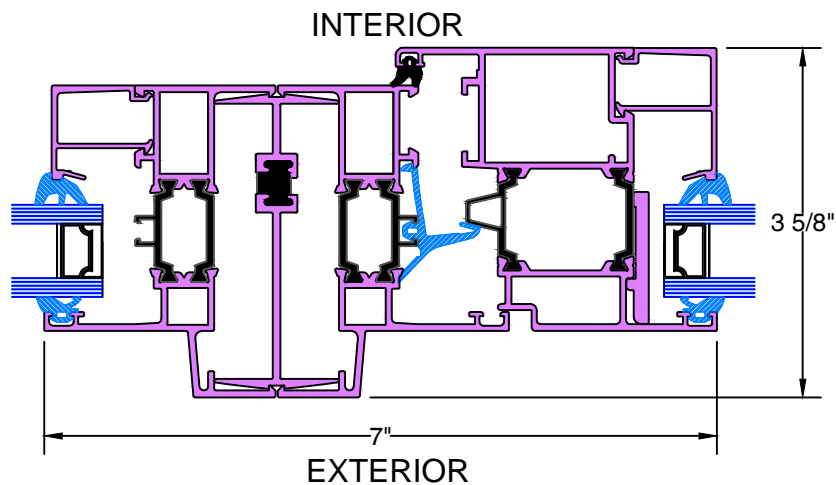
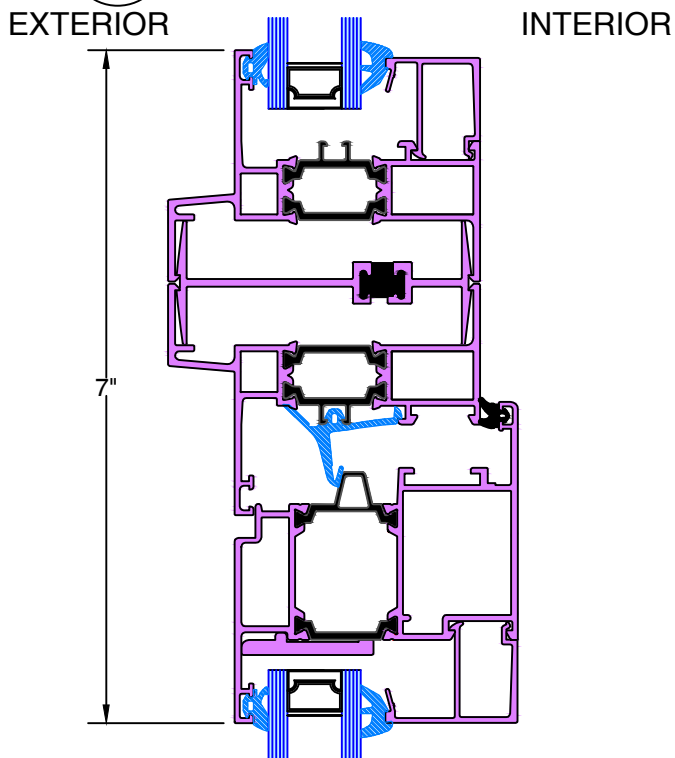

N TYPICAL STACKING MULLION

P TYPICAL JOINING MULLION

